

Ben Hill Griffin, Inc. - Shop 16 Comprehensive Plan Amendment

Avon Park, Florida

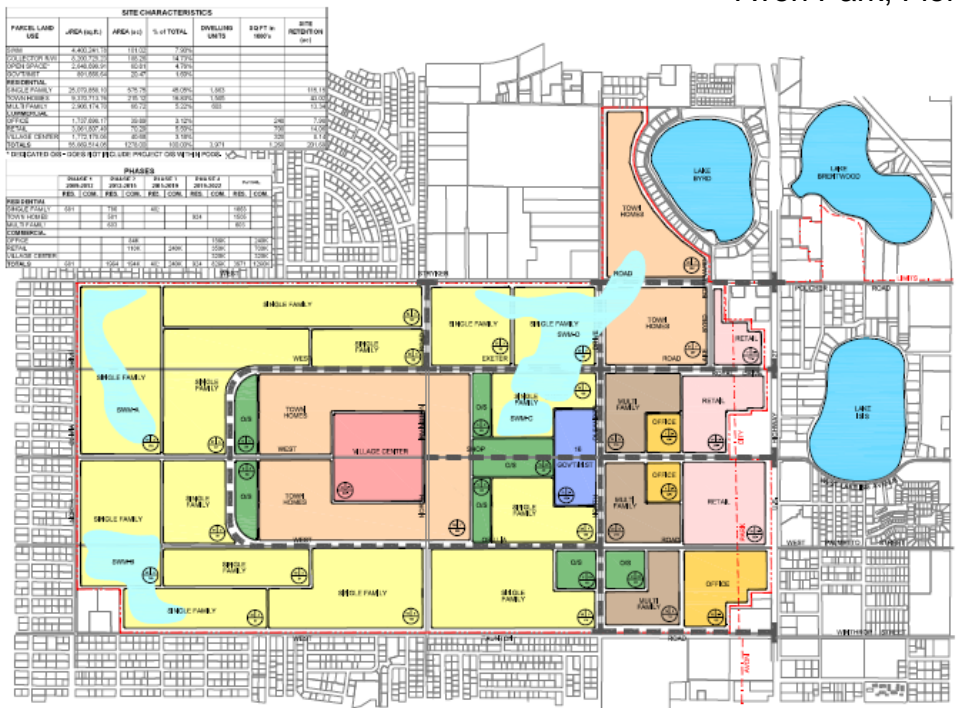

This multiuse development covers approximately 1,300 acres on the West side of US Highway 27.



This multi-phased Development of Regional Impact (DRI) contains over thirteen hundred (1,300) acres. To expedite its construction, JSK Consulting is preparing a development feasibility report to provide an evaluation of existing infrastructure and a capital improvement master plan.

JSK Consulting, Inc.'s responsibilities include the following:

- *Utility Planning:* preparation, simulation and analysis of a hydraulic model to document the adequacy of the proposed utility system design during peak hour demand and fire flow scenarios.
- *Civil/Environmental Engineering:* complete utility system design to include: multiple wastewater lift stations; gravity sewers; and on-site and off-site wastewater force mains and potable water distribution systems.

