

Shopping Center at Traditions

Winter Haven, Florida

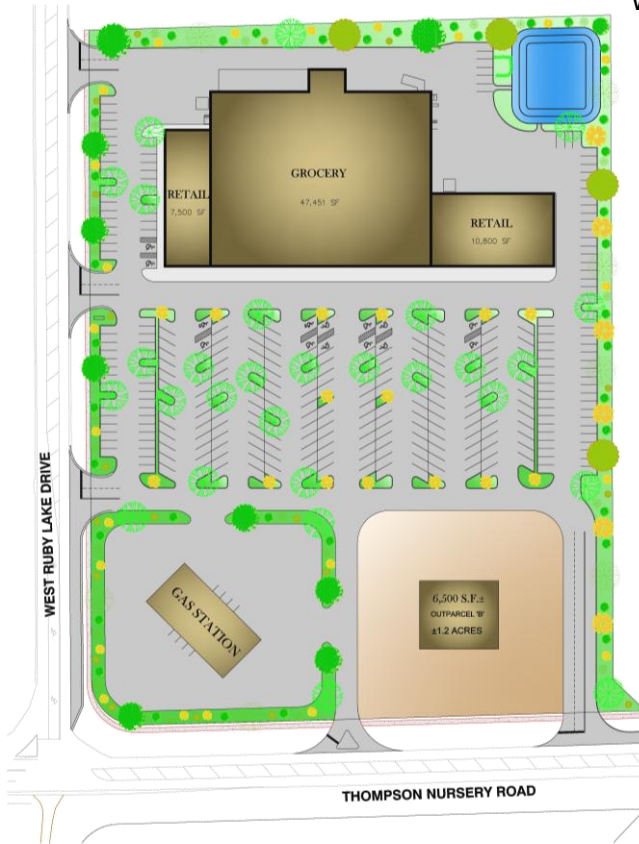

JSK Consulting, Inc. is currently working in conjunction with the Polk County Transportation Planning Division to prorate intersection improvements with adjoining Developers to expedite construction of this project.

JSK CONSULTING, INC.'s services for this project include complete site layout and engineering services to construct approximately seventy five thousand (75,000) square feet of commercial buildings with two future outparcels along Thompson Nursery Road and West Ruby Lake Drive. The project involves working together with several local and state regulatory agencies including: the City of Winter Haven, Polk County Access Management, the Southwest Florida Water Management District, the Florida Department of Environmental Protection and Polk County Health Department.

The services we provided include the following:

- *Civil/Environmental Engineering:* complete site development design to include: paving, grading and drainage system design and permitting; gravity sewer collection systems and force main design and permitting; reclaimed water distribution system design and permitting; preparation of construction plans and a Technical standards and specifications project manual; and construction management and administration.